

Experience the Modern living with  
Elegant Lifestyle



SITE MAP

map not to scale

Construction  
Work  
in  
Full Swing



**Sushant Jeevan Enclave**  
Premium 2 & 3 Bedroom Apartments



Golf Academy Operational



Ansal Institute of Technology & Management



Best Price - A Bharti Walmart Venture



G.D. Goenka Public School

**DELHI CORPORATE OFFICE**

115, Ansal Bhawan, 16 Kasturba Gandhi Marg, New Delhi 110001, Tel: 011-23353550, 66302268/69/70, Fax: 66302873

**LUCKNOW OFFICE**

1st Floor, YMCA Campus, 13, Rana Pratap Marg, Lucknow- 226001. Ph: 0522-4096200, Fax: 0522-2209510

Website: [www.ansalapi.com](http://www.ansalapi.com)  
SMS 'API' to **57575**



Grand Entrance



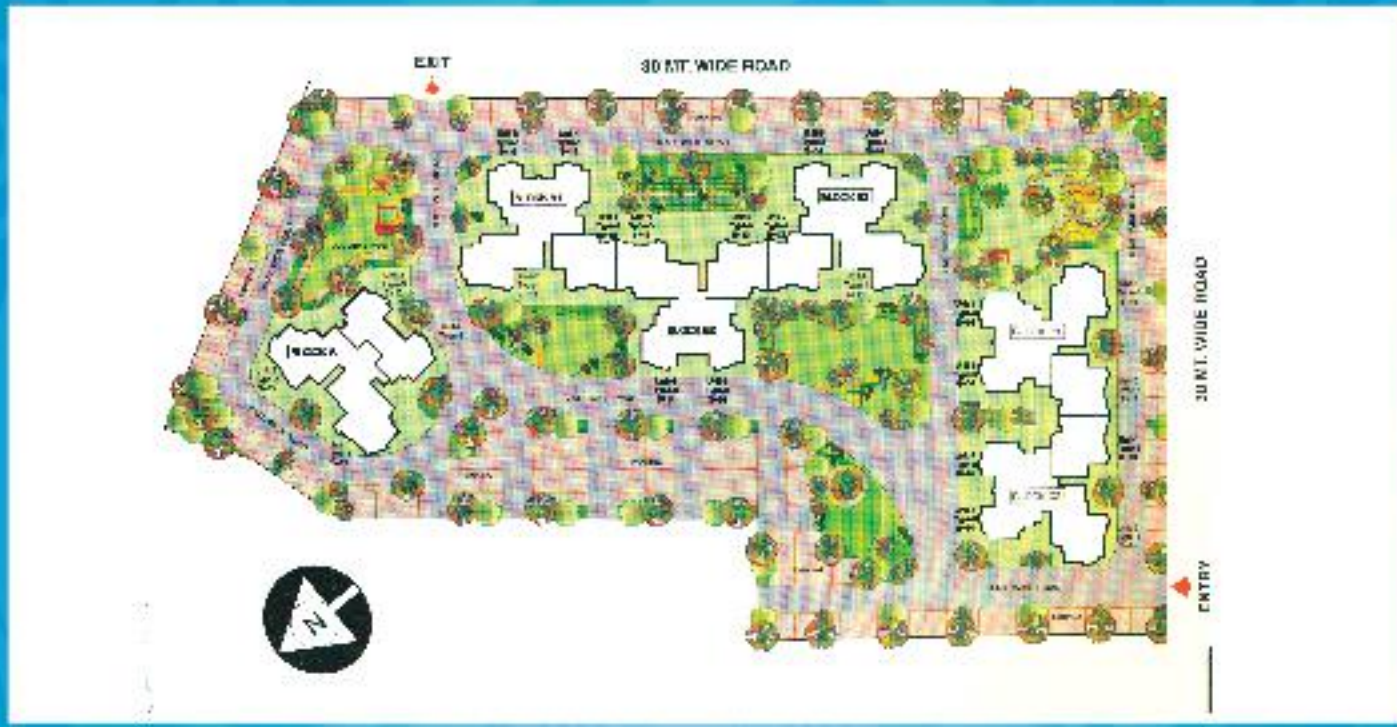

Sector J, Pocket 4, Sushant Golf City

### SPECIFICATIONS

Structure	: Frame structure conforming to BIS Seismic Codes
Floor Finishes	: Vitrified Tiles
Living / Dining	: Laminated Wooden Flooring
Bedrooms	: Marble / Kota
Stairs	: Non-skid ceramic tiles
Balconies	
Toilets	
Flooring	: Non-skid ceramic tiles / Porcelain Tiles
Walls	: Tiles as per Architectural Design
Chinaware	: European Type WC, Wash Basin with CP Fittings
Counter	: Marble / Granite
Water Supply	: The vision for Hot and Cold Water Supply
Other Fixtures	: Looking Mirror, Towel Ring / Rod, Paper holder, soap dish and health faucet
Kitchen	
Flooring	: Non-skid Ceramic Tiles or equivalent
dado	: Tiles cladding on walls as per architectural design
Water Supply	: Provision for Hot and Cold Water supply
Fittings	: CP Fittings with mixture
Sink	: Stainless steel sink with drain board
Joinery	
Windows	: UPVC/ Anodized Aluminium Powder Coated
Doors	: Seasoned Hardwood Frames with Modular Door Shutters. All doors shall have Decorative Fittings.
Wall Finishes	
Internal	: All wood work shall be finished with synthetic Enamel Paint. Drawing and Dining Rooms/Bedrooms Walls shall be finished with Plastic Emulsion Paints as per design
External	: Pleasing Elevation with Semi-Permanent Finish / All Weather Exterior Paints
OTHER FEATURE	
Electrical	: Copper Wiring in Conduits with Modular Switches
Telecommunication	: Provision of Telephone Points in Drawing Room, Dining Room and All Bedrooms Provision of TV Aerial Points in Drawing Room / Lobby and all Bedrooms

